

LEXMARK

Quick Setup



Note: See the enclosed safety information and license agreement sheets first. Do not proceed unless you agree with the license terms.

Thank you for choosing Lexmark!



We hope that you enjoy all the exciting features included with this special offer. This printer includes one #29 color print cartridge, which is designed to print both color and black-and-white documents. For even faster speeds and more dynamic print results, a #28 black or #31 photo print cartridge (sold separately) can be used in combination with the included color cartridge.

Follow the 3 easy steps below to set up the printer:

1

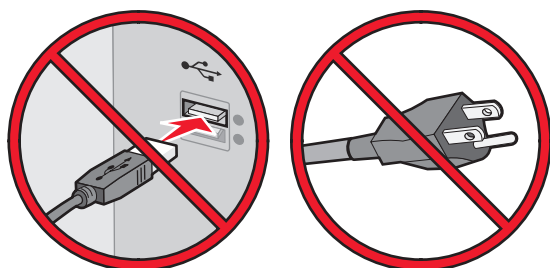

STOP!

Do not attach anything to the printer or plug anything into the wall outlet. Locate the installation software CD.

2

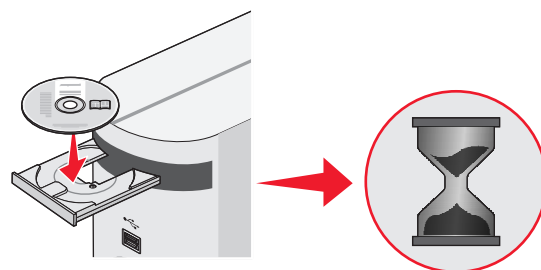

Insert the CD.

Note: If the Welcome screen does not appear after a minute, or if security or warning messages appear, or if you encounter other setup issues, then see the back of this page.

3

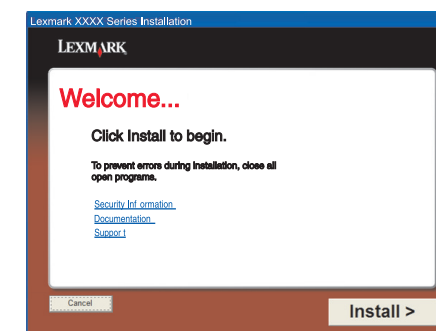

Follow the steps in the install wizard.



Setup Troubleshooting

Problem	Solution
Welcome screen does not appear automatically.	<i>Windows</i> 1 Do one of the following: <ul style="list-style-type: none">• In Windows Vista:<ol style="list-style-type: none">a Click .b Locate the Start Search box in the Start menu.• In Windows XP, click Start → Run. 2 Type D:\setup.exe , where D is the letter of your CD or DVD drive.
The message "Device driver software was not successfully installed" appears when you install on Windows Vista.	Continue following the instructions on the install wizard. Select the recommended option if the "Found New Hardware" message appears.
A "Found New Hardware" message appears.	1 Make sure the USB cable is not connected. 2 Click Cancel on any New Hardware screen. 3 Follow the instructions on the front of this sheet.
Security or warning messages appear on the computer screen during software installation.	Always allow the printer software to communicate with your computer system. This is necessary for setting up the printer.
Cannot find the printer on the network, or still having problems setting up the printer	See the <i>Getting Started</i> guide to find setup and network troubleshooting information.