

Menu map

Menus list

Paper Menu

Default Source
Paper Size/Type
Configure MP
Substitute Size
Paper Texture
Paper Weight
Paper Loading
Custom Types
Universal Setup

Security

Miscellaneous
Confidential Print
Security Audit Log
Set Date/Time

Reports

Menu Settings Page
Device Statistics
Network Setup Page
Wireless Setup Page
Profiles List
Netware Setup Page
Print Fonts
Print Directory
Asset Report

Settings

General Settings
Setup Menu
Finishing Menu
Quality Menu
Utilities Menu
XPS Menu
PDF Menu
PostScript Menu
PCL Emul Menu
HTML Menu
Image Menu

Network/Ports

Active NIC
Network Menu
USB Menu
Parallel Menu
SMTP Menu

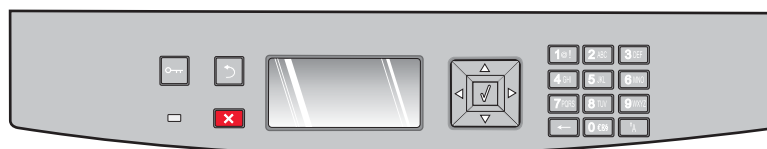

Understanding the printer control panel

The following diagram shows the printer control panel:



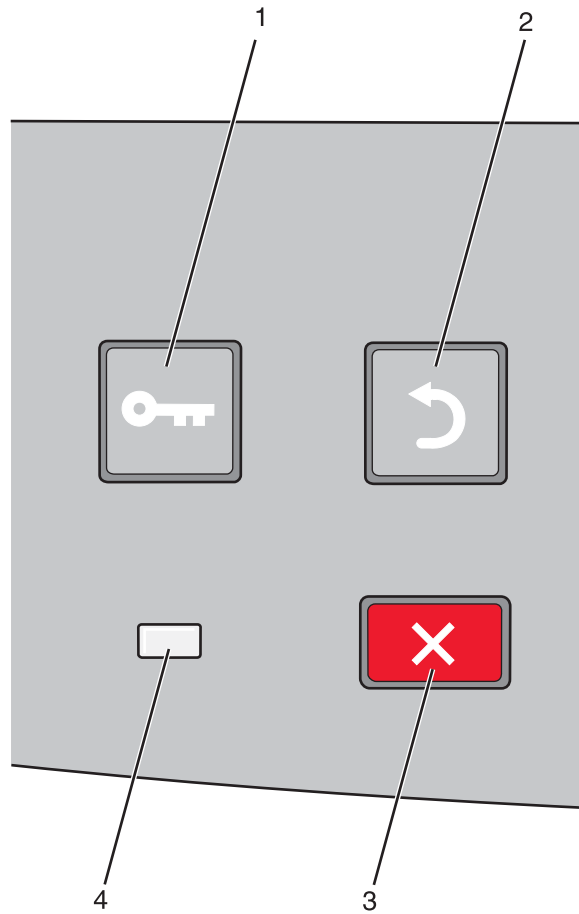

The following diagrams and tables provide more information about the printer control panel items:

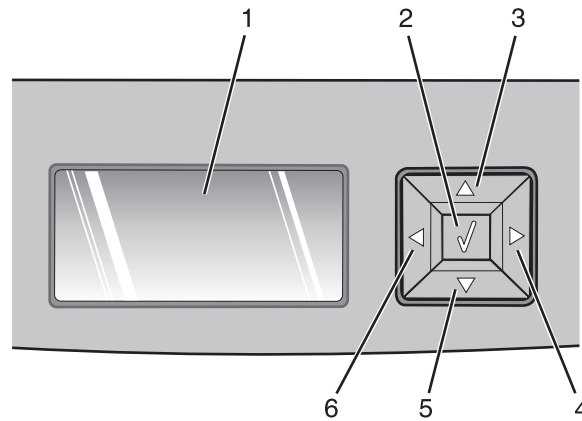

Item		Description
1	Menus button (🔑) 	Opens the menus Note: The menus are available only when the printer is in the Ready state.
2	Back button (↶) 	Returns the display to the previous screen
3	Stop button (❌) 	Stops all printer activity When printing, pressing ❌ causes Stopping to appear momentarily. Then the Stopped screen appears offering a list of settings that you may select.
4	Indicator light	Indicates the printer status: <ul style="list-style-type: none"> • Off—The power is off. • Blinking green—The printer is warming up, processing data, or printing. • Solid green—The printer is on, but idle. • Solid red—Operator intervention is needed.



Item		Description
1	Display	Shows messages that communicate the status of the printer or that indicate possible printer problems that must be resolved. The display is also capable of showing pictures of Show Me instructions, which show you how to perform a task like clearing a jam.
2	Select button (✓) 	<ul style="list-style-type: none"> • Opens a menu and displays the first item in the menu (called a menu item) • Opens a menu item and displays the available values or settings. The current user default setting is indicated by an asterisk (*). • Saves the displayed menu item as the new user default setting <p>Note: When a new setting is saved as the user default setting, it remains in effect until new settings are saved or until factory defaults are restored. Settings chosen from a software program can also change or override the user default settings selected from the printer control panel.</p>
3, 4, 5, 6	Navigation buttons 	<p>Press the up or down arrow buttons to scroll through menus, menu items, or settings (also called values or options), or to scroll between screens and menu options.</p> <p>Note: Each press of the up or down arrow buttons moves you one item in any list. Press the right or left arrow buttons to increase or decrease a value or to scroll through text that rolls to another screen.</p>

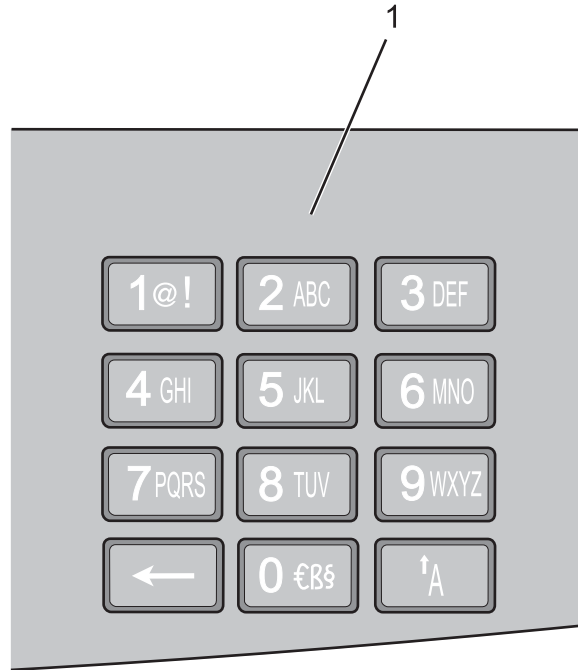

Item	Description	
1	Keypad	Enter numbers or symbols if the display screen has a field that accepts these entries.