



# E450dn

---

## Menus and Messages



**June 2006**

**[www.lexmark.com](http://www.lexmark.com)**

Lexmark and Lexmark with diamond design are trademarks of Lexmark International, Inc., registered in the United States and/or other countries.

© 2006 Lexmark International, Inc.

All rights reserved.

740 West New Circle Road  
Lexington, Kentucky 40550

**Edition: June 2006**

**The following paragraph does not apply to any country where such provisions are inconsistent with local law:** LEXMARK INTERNATIONAL, INC., PROVIDES THIS PUBLICATION "AS IS" WITHOUT WARRANTY OF ANY KIND, EITHER EXPRESS OR IMPLIED, INCLUDING, BUT NOT LIMITED TO, THE IMPLIED WARRANTIES OF MERCHANTABILITY OR FITNESS FOR A PARTICULAR PURPOSE. Some states do not allow disclaimer of express or implied warranties in certain transactions; therefore, this statement may not apply to you.

This publication could include technical inaccuracies or typographical errors. Changes are periodically made to the information herein; these changes will be incorporated in later editions. Improvements or changes in the products or the programs described may be made at any time.

Comments about this publication may be addressed to Lexmark International, Inc., Department F95/032-2, 740 West New Circle Road, Lexington, Kentucky 40550, U.S.A. In the United Kingdom and Eire, send to Lexmark International Ltd., Marketing and Services Department, Westhorpe House, Westhorpe, Marlow Bucks SL7 3RQ. Lexmark may use or distribute any of the information you supply in any way it believes appropriate without incurring any obligation to you. To obtain additional copies of publications related to this product, visit the Lexmark Web site at [www.lexmark.com](http://www.lexmark.com).

References in this publication to products, programs, or services do not imply that the manufacturer intends to make these available in all countries in which it operates. Any reference to a product, program, or service is not intended to state or imply that only that product, program, or service may be used. Any functionally equivalent product, program, or service that does not infringe any existing intellectual property right may be used instead. Evaluation and verification of operation in conjunction with other products, programs, or services, except those expressly designated by the manufacturer, are the user's responsibility.

© 2006 Lexmark International, Inc.

All rights reserved.

**UNITED STATES GOVERNMENT RIGHTS**

This software and any accompanying documentation provided under this agreement are commercial computer software and documentation developed exclusively at private expense.

# Contents

<b>Chapter 1: Using printer menus .....</b>	<b>4</b>
Understanding the printer control panel .....	5
Menu Groups .....	7
Paper Menu .....	7
Reports .....	12
Settings .....	13
PPDS Menu .....	22
Security .....	23
Network/Ports .....	24
Help .....	27
<b>Chapter 2: Understanding printer messages .....</b>	<b>28</b>
<b>Index .....</b>	<b>34</b>

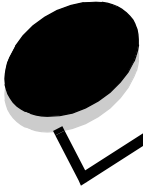

# Using printer menus

A number of menus are available to make it easy for you to change printer settings. The diagram shows the menu index on the control panel, the menus, and items available under each menu. The items in each menu and the values you can select are described in more detail later in this chapter.

Some menu items or values are displayed only if a specific option is installed on the printer. Other menu items may only be effective for a particular printer language. You can select these values at any time, but they only affect printer function when you have the optional equipment or the specified printer language.

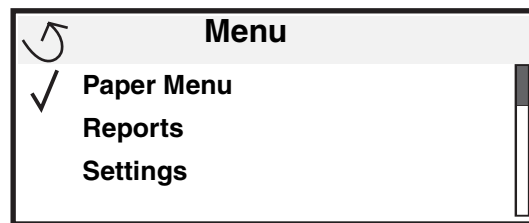

## **Paper Menu**

- Default Source
- Paper Size/Type
- Substitute Size
- Paper Texture
- Paper Weight
- Paper Loading
- Custom Types
- Universal Setup

## **Reports**

- Menu Settings Page
- Device Statistics
- Network Setup Page
- Print Fonts
- Print Demo

## **Settings**

- Setup Menu
- Finishing Menu
- Quality Menu
- Utilities Menu
- PostScript Menu
- PCL Emul Menu

## **Network/Ports**

- TCP/IP
- Standard Network
- Standard USB
- AppleTalk

## **PPDS Menu**

- Job Expiration

## **Help**

- Printing Guide
- Supplies Guide
- Media Guide
- Print Defects
- Menu Map
- Information Guide
- Connection Guide
- Moving Guide



## Understanding the printer control panel

The control panel consists of these items:

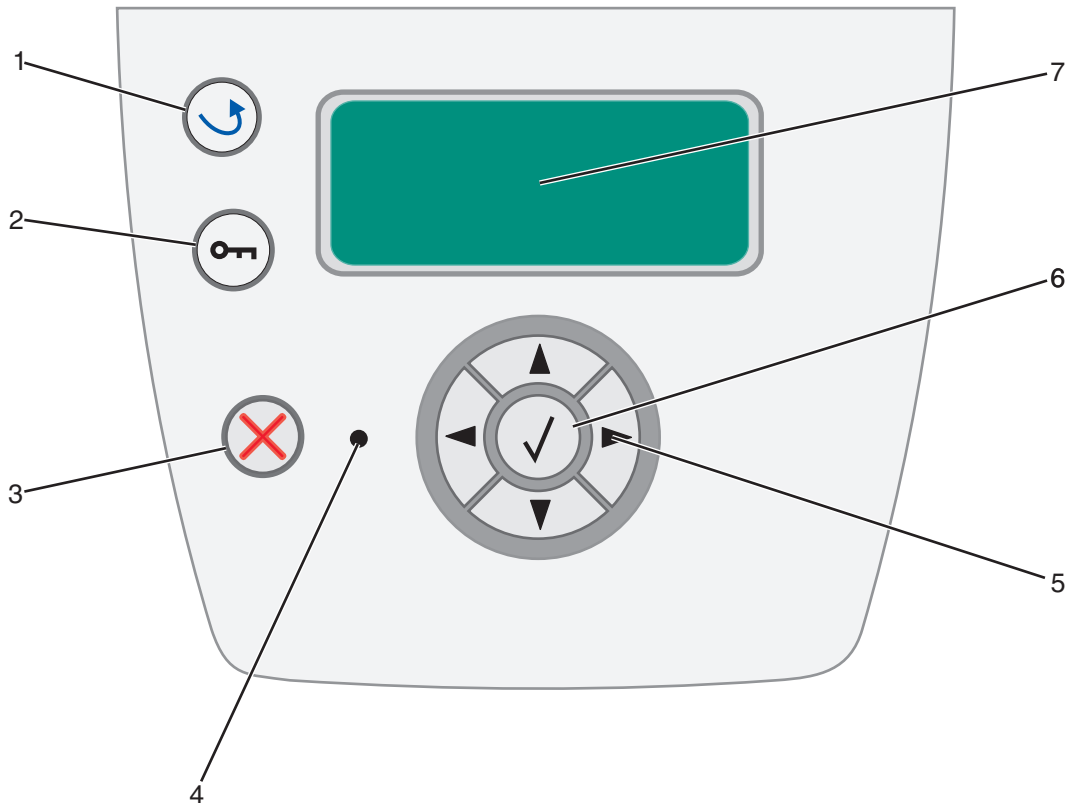
- A 4-line, back-lit, gray-scale display that can show both graphics and text
- Eight buttons: Back, Menu, Stop, Select ( ✓ ), ▲, ▼, ►, and ◀
- Indicator light



The use of the buttons and the layout of the display panel are described in the following table.

Button or control panel item	Function
<b>1 Back</b> 	To return to the last screen viewed. <b>Note:</b> Changes made on a screen will not be applied if you press the <b>Back</b> button.
<b>2 Menu</b> 	To open the menu index. <b>Note:</b> The printer must be in the <b>Ready</b> state to access the menu index. A message indicating the menus are unavailable will appear if the printer is not ready.
<b>3 Stop</b> 	To stop the mechanical operation of the printer. After pressing <b>Stop</b> , the message <b>Stopping</b> appears. When the printer has stopped, the status line in the control panel will show <b>Stopped</b> , and a list of options will appear.

## Using printer menus

---

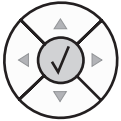
Button or control panel item	Function										
<b>4 Indicator light</b>	<p>A two-toned LED is used on the control panel, one color being green and the other being red. The lights indicate whether the printer power is on, the printer is busy, idle, processing a job, or requires operator intervention.</p> <table border="1" style="margin-left: auto; margin-right: auto; border-collapse: collapse; width: 80%;"> <thead> <tr style="background-color: #444; color: white;"> <th style="padding: 2px 5px;">Status</th> <th style="padding: 2px 5px;">Indicates</th> </tr> </thead> <tbody> <tr> <td style="padding: 2px 5px;">Off</td> <td style="padding: 2px 5px;">Power is off.</td> </tr> <tr> <td style="padding: 2px 5px;">Solid green</td> <td style="padding: 2px 5px;">Printer is on, but idle.</td> </tr> <tr> <td style="padding: 2px 5px;">Flashing green</td> <td style="padding: 2px 5px;">Printer is warming up, processing data, or printing a job.</td> </tr> <tr> <td style="padding: 2px 5px;">Solid red</td> <td style="padding: 2px 5px;">Operator intervention is required.</td> </tr> </tbody> </table>	Status	Indicates	Off	Power is off.	Solid green	Printer is on, but idle.	Flashing green	Printer is warming up, processing data, or printing a job.	Solid red	Operator intervention is required.
Status	Indicates										
Off	Power is off.										
Solid green	Printer is on, but idle.										
Flashing green	Printer is warming up, processing data, or printing a job.										
Solid red	Operator intervention is required.										
<b>5 and 6 Navigation buttons</b>  	<p>The <b>Up</b> and <b>Down</b> buttons are used to move up and down lists.</p> <p style="margin-left: 20px;">▲ ▼</p> <p>When navigating through a list using the <b>Up</b> or <b>Down</b> button, the cursor moves one line at a time. Pressing the <b>Down</b> button at the bottom of the screen changes the screen to the next whole page.</p> <hr/> <p>The <b>Left</b> and <b>Right</b> buttons are used to move within a screen, such as moving from one menu index item to another. They are also used to scroll through text that will not fit on the screen.</p> <p style="margin-left: 20px;">◀   ▶</p> <hr/> <p>The <b>Select</b> button is used to initiate action on a selection. Press <b>Select</b> when the cursor is next to the selection you want, such as following a link, submitting a configuration item, or to start or cancel a job.</p> <p style="margin-left: 20px;">⊙ ✓</p>										
<b>7 Display</b>	<p>The display shows messages and graphics describing the current state of the printer and indicating possible printer problems you must resolve.</p> <p>The top line of the display is the header line. If applicable, it will contain the graphic indicating the Back button can be used. It will also display the current status and the Supplies (Warnings) status. If multiple warnings are present, each warning will be separated by a comma.</p> <p>The other three lines of the display are the body of the screen. This is where you view printer status, supplies messages, Show me screens, and make selections.</p>										

## Menu Groups

**Note:** An asterisk (\*) next to a value indicates the default setting.

### Paper Menu

Use the Paper Menu to define the paper loaded in each paper tray, the default paper source, and the output bin.

#### Default Source

Menu selection	Purpose	Values	
Default Source	Identifies the default paper source	Tray <x>	If you loaded the same size and type of paper in two paper sources (and the Paper Size and Paper Type menu items are correctly set), the trays are automatically linked. When one paper source is empty, paper automatically feeds from the next linked source.
		Manual Paper	
		Manual Env	

#### Paper Size/Type

**Note:** Only installed paper sources are displayed.

This menu selection is used to set the size and type of media loaded into an input tray. Setting the paper size and type is a two-step process. In the first menu selection, *Size* appears in bold letters. After you select the media size, the screen will change, and *Type* appears in bold letters. You can then select the media type.

Menu selection	Purpose	Values	
Tray <x> <b>Size/Type</b>	Identifies the default paper size for this paper source	A4* (non-Americas) A5 A6 JIS B5 Letter* (Americas) Legal Executive Folio Statement 7 3/4 Envelope 9 Envelope	If you loaded the same size and type of paper in two paper sources (and the Paper Size and Paper Type menu items are correctly set), the trays are automatically linked. When one paper source is empty, paper automatically feeds from the next linked source.

## Using printer menus

---

Menu selection	Purpose	Values
Tray <x> Size/ <b>Type</b>	Identifies the type of paper installed in this paper source  <b>Note:</b> If a user-defined name is available, it appears instead of <b>Custom Type &lt;x&gt;</b> . If two or more custom types share the same name, the name only appears once in the Paper Type list.	Plain Paper Card Stock Transparency Labels Bond Envelope Letterhead Preprinted Colored Paper Light Paper Heavy Paper Rough/Cotton Paper Custom Type <x>
Manual Paper Size/ <b>Type</b>	Identifies the paper size being manually loaded	A4* (non-Americas) A5 A6 JIS B5 Letter* (Americas) Legal Executive Folio Statement Universal
Manual Paper Size/ <b>Type</b>	Identifies the paper type being manually loaded	Plain Paper Card Stock Transparency Labels Bond Letterhead Preprinted Colored Paper Light Paper Heavy Paper Rough/Cotton Paper Custom Type <x>
Manual Envelope Size/ <b>Type</b>	Identifies the envelope size being manually loaded	7 3/4 Envelope 9 Envelope 10 Envelope* (US) DL Envelope* (non-US) C5 Envelope B5 Envelope Other Envelope
Manual Envelope Size/ <b>Type</b>	Identifies the envelope type being manually loaded	Envelope* Custom Type <x>



## Using printer menus

---

### Substitute Size

This menu selection is used to determine whether the printer can substitute another size paper if the requested paper size is not currently installed in any of the printer input sources. If, for example, Substitute Size is set to Letter/A4, and only letter size paper is installed in the printer. When a request is received to print on A4 paper, the printer will substitute letter for A4 and print the job instead of displaying a change paper request.

Menu selection	Purpose	Values	
Substitute Size	Substitutes the specified paper size if the requested size is not loaded	Off Statement/A5 Letter/A4 All Listed*	The <b>All Listed</b> value indicates that all available substitutions are allowed.

### Paper Texture

This menu selection is used to set the media texture for each of the defined media types. This allows the printer to optimize the print quality for the specified media.

Menu selection	Purpose	Values	
Plain Texture	Identifies the texture of the media loaded in a specific input source	Smooth Normal* Rough	
Transparency Texture			
Labels Texture			
Bond Texture			
Envelope Texture			
Letterhead Texture			
Preprinted Texture			
Colored Texture			
Light Texture			
Heavy Texture			
Rough/Cotton Texture			
Card Stock Texture	Identifies the texture of the card stock loaded in a specific input source	Smooth Normal* Rough	Shown if Card Stock is supported in the specified input source.
Custom <x> Texture	Identifies the texture of the custom media loaded in a specific input source	Smooth Normal* Rough	Shown if the custom type is supported in the specified input source.

## Using printer menus

---

### Paper Weight

This menu selection is used to set the paper weight for each of the defined media types. This allows the printer to optimize the print quality for the media weight.

Menu selection	Purpose	Values	
Plain Weight	Identifies the weight of the media loaded in a specific input source	Light Normal* Heavy	
Transparency Weight			
Labels Weight			
Bond Weight			
Envelope Weight			
Letterhead Weight			
Preprinted Weight			
Colored Weight			
Light Weight			
Heavy Weight			
Rough/Cotton Weight			
Card Stock Weight	Identifies the weight of the card stock loaded in a specific input source	Light Normal* Heavy	Shown if Card Stock is supported in the specified input source.
Custom <x> Weight	Identifies the weight of the custom media loaded in a specific input source	Light Normal* Heavy	Shown if the custom type is supported in the specified input source.

### Paper Loading

This menu selection is used to set the loading orientation for each paper type. This lets you load an input source with preprinted media, and then notify the printer that the media is loaded for duplex printing. You can then use your application software to indicate simplex printing. When simplex printing is selected, the printer automatically inserts blank pages to print the simplex job correctly.

**Note:** Paper Loading is only available if a duplex unit is installed.

Menu selection	Purpose	Values	
Labels Loading	Properly handles preprinted paper whether the job is a duplexed or single-sided job	Duplex Off*	
Bond Loading			
Letterhead Loading			
Preprinted Loading			
Colored Loading			
Light Loading			
Heavy Loading			
Rough/Cotton Loading			

## Using printer menus

---

Menu selection	Purpose	Values	
Card Stock Loading	Properly handles preprinted card stock whether the job is a duplexed or single-sided job	Duplex Off*	Shown if Card Stock is supported in the specified input source.
Custom <x> Loading	Properly handles preprinted custom paper whether the job is a duplexed or single-sided job	Duplex Off*	Shown if the custom type is supported in the specified input source.

### Custom Types

This menu selection is used to define a name for each custom paper type. You can assign names using a utility such as MarkVision Professional or from the control panel.

Menu selection	Purpose	Values	
Custom Type <x>	Specifies the type of paper associated with each Custom Type available in the Paper Type menu	Paper* Card Stock Transparency Labels Envelope	The custom type media must be supported in the input source you designate in order to assign a user-defined name.  Once the name is assigned, the name (truncated to 16 characters) will be displayed instead of <b>Custom Type x</b> .

### Universal Setup

This menu selection is used to specify the height and width of the Universal Paper Size. By specifying the height and width for Universal Paper Size, the printer will use the Universal setting exactly like other paper sizes, including support for duplex and n-up.

Menu selection	Purpose	Values	
Units of Measure	Determines the unit of measure used to enter the Universal Height and Width	Inches* (US) Millimeters* (non-US)	Inches is the US default; Millimeters is the international default.
Portrait Width	Sets the portrait width of the universal media <b>Note:</b> If the value set exceeds the maximum width, the printer will use the maximum value allowed in inches or millimeters.	3 inches to 14.17 inches in 0.01 inch increments* (US) 76 mm to 360 mm in 1 mm increments* (non-US)	Shows either inches or mm from Units of Measure setting; 8.5 inches is the US default, and 216 mm is the international default.
Portrait Height	Sets the portrait height of the universal media <b>Note:</b> If the value set exceeds the maximum height, the printer will use the maximum value allowed in inches or millimeters.	3 inches to 14.17 inches in 0.01 inch increments* (US) 76 mm to 360 in 1 mm increments* (non-US)	Shows either inches or mm from Units of Measure setting; 14 inches US default, and 355 mm is the international default.
Feed Direction	Specifies the feed direction	Short Edge* Long Edge	Long Edge is only shown if the longest edge is shorter than the Maximum Physical Width of the printer.

### Reports

#### Menu Settings Page

This menu selection prints a menu settings page.

Menu selection	Purpose	Values
Menu Settings Page	Prints information relating to the default printer settings and verifies that printer options are installed correctly	After selecting this item, the page will print and the printer will return to <b>Ready</b> .

#### Device Statistics

This menu selection displays the printer statistics.

Menu selection	Purpose	Values
Device Statistics	Prints information relating to the printer statistics	After selecting this item, the page will print and the printer will return to <b>Ready</b> .

#### Network Setup Page

This menu selection prints a network setup page.

Menu selection	Purpose	Values
Network Setup Page	Prints information relating to network settings and verifies the network connection  <b>Note:</b> This page also provides information that helps you configure for network printing.	After selecting this item, the page will print, and the printer will return to <b>Ready</b> .

#### Print Fonts

This menu selection prints a list of the fonts stored in the printer.

Menu selection	Purpose	Values	
Print Fonts	Prints a sample of all the fonts available for the selected printer language	PCL Fonts	Prints a sample of all printer fonts available for PCL emulation
		PS Fonts	Prints a sample of all printer fonts available for PostScript emulation
		PPDS Fonts	Prints a sample of all printer fonts available for PPDS emulation. Only available if PPDS emulation is active

## Using printer menus

---

### Print Demo

This menu selection shows a list of demonstration pages that are available.

Menu selection	Purpose	Values	
Print Demo	Prints a demonstration page	Demo Page	After selecting this item, the page will print, and the printer will return to <b>Ready</b> . <b>Note: PPDS Info</b> Only available if PPDS emulation is active.
		PPDS Info	
		[List of resident demo pages]	

### Settings

#### Setup Menu

Use this menu selection to configure a variety of printer features.

Menu selection	Purpose	Values	
Display Language	Determines the language of the text displayed on the control panel	English	<b>Note:</b> All values may not be available.
		Français	
		Deutsch	
		Italiano	
		Español	
		Dansk	
		Norsk	
		Nederlands	
		Svenska	
		Português	
		Suomi	
		Russian	
		Polski	
		Magyar	
		Turkish	
		Czech	
Simplified Chinese			
Traditional Chinese			
Korean			
Japanese			

## Using printer menus

---

Menu selection	Purpose	Values	
Eco-Mode	The printer minimizes waste (toner, paper, energy) while maintaining acceptable print quality.	Off*	No changes in operation are made.
		Energy	The following options are changed: <ul style="list-style-type: none"> <li>• Duplex is turned off.</li> <li>• LCD panel's power indicator LED and backlight remain off.</li> <li>• Ready mode is disabled.</li> <li>• Advance start command is ignored.</li> </ul>
		Energy/Paper	Same options as Energy option, except Duplex is turned on.
Quiet Mode	The printer operates quietly by printing output at a slower speed.	Off*	No changes in operation are made.
		On	The following options are changed: <ul style="list-style-type: none"> <li>• LCD panel's power indicator LED remains illuminated when in Ready state and blinks when in Busy state</li> <li>• All print jobs print at half speed.</li> <li>• Fuser standby mode is enabled.</li> <li>• Advance start command is ignored.</li> </ul> <b>Note:</b> The engine prints at half speed in all resolutions.
Power Saver	Specifies the amount of time (in minutes) the printer waits after a job is printed before it goes into a reduced power state	Disabled	This value does not appear unless Energy Conserve is set to Off. For more information, see the <i>User's Guide</i> on the <i>Software and Documentation CD</i> . <b>Note:</b> <b>Disabled</b> is not a valid choice with <b>Energy Conserve</b> set to <b>On</b> .
		1...240	Auto power saver is enabled. Select a value to control how long the control panel backlight stays on, and how long the <b>Ready</b> message is displayed before the <b>Power Saver</b> message appears.
Toner Alarm	Controls whether the printer sounds an alarm when the printer requires operator intervention	Off On*	<b>Off</b> —Printer will display a warning and continue printing pages. <b>On*</b> —Printer will display a warning and stop printing pages.

## Using printer menus

Menu selection	Purpose	Values	
Timeouts	<p>Specifies the amount of time (in seconds) the printer waits to return to the home screen, receive an end-of-job message, or receive additional bytes of data from the computer</p> <p><b>Note:</b> Wait Timeout is only available when you use PostScript emulation. This menu value has no effect on PCL emulation print jobs.</p>	Screen Timeout: 15–300 (30*)	<b>15–300</b> —Specifies the amount of time the printer waits before returning to the home screen. <b>30*</b> is the default setting.
		Print Timeout: Disabled 1–255 (90*)	<b>Disabled</b> —Disables Print Timeout. <b>1–255</b> —Specifies the amount of time the printer waits for an end-of-job message before canceling the remainder of the print job. <b>Note:</b> When the timer expires, any partially formatted page still in the printer is printed, and other input ports are examined to see if data exists. <b>90*</b> is the default setting.
		Wait Timeout: Disabled 15...65535 (40*)	<b>Disabled</b> —Disables Wait Timeout. <b>15...65535</b> —Specifies the amount of time the printer waits for additional data before it cancels the job. <b>40*</b> is the default setting.
		Network Job Timeout: 0–255 (90*)	<b>0–255</b> —Specifies the amount of time the printer waits before returning to the home screen. <b>90*</b> is the default setting.
Print Recovery	<p>Specifies whether the printer continues from certain offline situations, reprints jammed pages, or waits until the entire page is processed and ready to be printed</p>	Auto Continue: Disabled* 5–255	Lets the printer automatically continue from certain offline situations when not resolved within the specified time period. <b>5–255</b> —Specifies the amount of time the printer waits.
		Jam Recovery: On Off Auto*	Specifies whether the printer reprints jammed pages. <b>On</b> —Printer reprints jammed pages. <b>Off</b> —Printer does not reprint jammed pages. <b>Auto*</b> —Printer reprints a jammed page unless the memory required to hold the page is needed for other printer tasks.
		Page Protect: Off* On	Successfully prints a page that may otherwise generate <b>Complex Page</b> errors. <b>Off*</b> —Prints a partial page of data if memory is insufficient to process the entire page. <b>On</b> —Ensures that an entire page is processed before it prints. <b>Note:</b> If, after selecting On, you still cannot print the page, you may also have to reduce the size and number of fonts on the page, or increase the installed printer memory. <b>Note:</b> For most print jobs, you do not need to select On. When On is selected, printing may be slower.

## Using printer menus

Menu selection	Purpose	Values	
Printer Language	Specifies the default printer language used to communicate data from the computer to the printer <b>Note:</b> Setting a printer language as the default does not prevent a software application from sending print jobs that use the other language.	PCL Emulation* PS Emulation PPDS Emulation	<b>PCL emulation</b> —Uses a PCL interpreter for incoming host communications. <b>PostScript emulation</b> —Uses a PS interpreter for incoming host communications. <b>PPDS emulation</b> —Uses a PPDS interpreter for incoming host communications.
Print Area	Modifies the logical and physical printable area	Normal* Fit to Page Whole Page	<b>Note:</b> The Whole Page setting only affects pages printed using PCL 5 interpreter. This setting has no effect on pages printed using the PCL XL or PostScript interpreters. If you try to print any data in the non-printable area defined by Normal Print Area, the printer will clip the image at the boundary defined by the Normal defined printable area.
Download Target	Specifies the storage location for downloaded resources. Storing downloaded resources in flash memory is permanent storage rather than the temporary storage that RAM provides. The resources remain in the flash memory even when the printer is turned off.	RAM*	All downloaded resources are automatically stored in printer memory (RAM).
		Flash	All downloaded resources are automatically stored in flash memory.
Resource Save	Specifies what the printer does with downloaded resources, such as fonts and macros stored in RAM, if the printer receives a job that requires more memory than is available	Off*	Printer retains downloaded resources only until memory is needed. It then deletes those resources associated with the inactive printer language.
		On	Printer retains all downloaded resources for all printer languages during language changes and printer resets. If the printer runs out of memory, <b>38 Memory Full</b> appears.
Page Protect	Successfully prints a page that may otherwise generate <b>Complex Page</b> errors  If, after selecting On, you still cannot print the page, you may also have to reduce the size and number of fonts on the page, or increase the installed printer memory.  For most print jobs, you do not need to select On. When On is selected, printing may be slower.	Off*	Prints a partial page of data if memory is insufficient to process the entire page
		On	Ensures that an entire page is processed before it prints

### Finishing Menu

Use this menu selection to define how the printer delivers the printed output.

Menu selection	Purpose	Values	
Duplex	Sets duplexing as the default for all print jobs <b>Note:</b> Select <b>Duplex</b> from the printer driver to duplex only specific jobs.	Off*	Prints on one side of the paper
		On	Prints on both sides of the paper



## Using printer menus

---

Menu selection	Purpose	Values	
Duplex Bind	Defines the way duplexed pages would be bound, and how the printing on the back of the sheet (even-numbered pages) is oriented in relation to the printing on the front (odd-numbered pages)	Long Edge*	Assumes binding along the long edge of the page (left edge for portrait orientation and top edge for landscape orientation)
		Short Edge	Assumes binding along the short edge of the page (top edge for portrait orientation and left edge for landscape orientation)
Copies	Sets the number of copies you want for the printer default value <b>Note:</b> Set the number of copies required for a specific job from the printer driver.	1...999 (1*)	Values selected from the printer driver always override values selected from the control panel.
Blank Pages	Specifies whether to include application-generated blank pages as part of your printed output	Do Not Print*	Does not print application-generated blank pages as part of your job.
		Print	Prints application-generated blank pages as part of your job.
Collation	Keeps the pages of a print job stacked in sequence when printing multiple copies of the job	Off*	Prints each page of a job the number of times specified by the Copies menu item. For example, if you set Copies to 2, and send three pages to print, the printer prints page 1, page 1, page 2, page 2, page 3, page 3.
		On	Prints entire job the number of times specified by the Copies menu item. For example, if you set Copies to 2, and send three pages to print, the printer prints page 1, page 2, page 3, page 1, page 2, page 3.
Separator Sheets	Inserts blank separator sheets between jobs, between multiple copies of a job, or between each page of a job	None*	Does not insert separator sheets.
		Between Copies	Inserts a blank sheet between each copy of a job. If Collation is Off, a blank page is inserted between each set of printed pages (all page 1's, all page 2's, and so on). If Collation is On, a blank page is inserted between each collated copy of the job.
		Between Jobs	Inserts a blank sheet between jobs.
		Between Pages	Inserts a blank sheet between each page of a job. This is useful if you are printing transparencies or want to insert blank pages in a document for notes.
Separator Source	Specifies the paper source that holds separator sheets	Tray <x> (Tray 1*)	Selects separator sheets from the specified tray
Multipage Print	Prints multiple-page images on one side of a sheet of paper. Also called <i>n-up</i> or <i>Paper Saver</i>	Off*	Prints 1 page image per side
		2 Up	Prints 2 page images per side
		3 Up	Prints 3 page images per side
		4 Up	Prints 4 page images per side
		6 Up	Prints 6 page images per side
		9 Up	Prints 9 page images per side
		12 Up	Prints 12 page images per side
		16 Up	Prints 16 page images per side

## Using printer menus

Menu selection	Purpose	Values																		
Multipage Order	Determines the positioning of multiple page images when using Multipage Print The positioning depends on the number of images and whether the images are portrait or landscape in orientation.	Horizontal*																		
		Vertical																		
		Reverse Horizontal																		
		Reverse Vertical																		
	For example, if you select 4-Up multipage printing and portrait orientation, the results differ depending on the Multipage Order value you select:																			
	<b>Horizontal Order</b>	<b>Vertical Order</b>	<b>Reverse Horizontal Order</b>	<b>Reverse Vertical Order</b>																
	<table border="1" style="width: 100px; height: 100px;"> <tr><td style="text-align: center;">1</td><td style="text-align: center;">2</td></tr> <tr><td style="text-align: center;">3</td><td style="text-align: center;">4</td></tr> </table>	1	2	3	4	<table border="1" style="width: 100px; height: 100px;"> <tr><td style="text-align: center;">1</td><td style="text-align: center;">3</td></tr> <tr><td style="text-align: center;">2</td><td style="text-align: center;">4</td></tr> </table>	1	3	2	4	<table border="1" style="width: 100px; height: 100px;"> <tr><td style="text-align: center;">2</td><td style="text-align: center;">1</td></tr> <tr><td style="text-align: center;">4</td><td style="text-align: center;">3</td></tr> </table>	2	1	4	3	<table border="1" style="width: 100px; height: 100px;"> <tr><td style="text-align: center;">3</td><td style="text-align: center;">1</td></tr> <tr><td style="text-align: center;">4</td><td style="text-align: center;">2</td></tr> </table>	3	1	4	2
1	2																			
3	4																			
1	3																			
2	4																			
2	1																			
4	3																			
3	1																			
4	2																			
Multipage View	Determines the orientation of a multipage sheet	Auto*	Lets the printer choose between portrait and landscape orientation.																	
		Long Edge	Sets the long edge of the paper as the top of the page (landscape)																	
		Short Edge	Sets the short edge of the paper as the top of the page (portrait)																	
Multipage Border	Prints a border around each page image when using Multipage Print	None*	Does not print a border around each page image																	
		Solid	Prints a solid line border around each page image																	

### Quality Menu

Use this menu selection to change settings that affect print quality and save toner.

Menu selection	Purpose	Values	
Print Resolution	Selects printed output resolution	300 dpi 600 dpi 1200 dpi 1200 Image Q 2400 Image Q*	
Toner Darkness	Lightens or darkens printed output	1–10	<b>8*</b> is the default setting. Select a lower number to lighten the printed output or save toner.
Small Font Enhancer	Enhances the quality of small fonts	Off* Fonts Only Fonts/Images	

## Using printer menus

---

### Utilities Menu

Use this menu selection to change printer settings, remove jobs, set up printer hardware, and troubleshoot printer problems.

Menu selection	Purpose	Values	
Factory Defaults	Returns printer settings to the factory default values	Do Not Restore*	User-defined settings remain.
		Restore Now	All menu items are returned to the factory default values except: <ul style="list-style-type: none"> <li>• Display Language.</li> <li>• All settings in the Parallel Menu, Network Menu, and USB Menu.</li> <li>• Resources residing in flash memory or on the hard disk.</li> </ul> <b>Note:</b> All downloaded resources (fonts, macros, and symbol sets) in printer memory (RAM) are deleted.
Format Flash	Formats the flash memory card <b>Note:</b> This option is only available if a flash memory card is installed, is not write protected, and is not defective.	No*	No changes are made to the flash memory card.
		Yes	Clears the contents of the flash memory card
Defragment Flash	Reclaims any fragmented space on the flash memory card <b>Note:</b> This option is only available if a flash memory card is installed, is not write protected, and is not defective.	No*	No changes are made to the flash memory card.
		Yes	Defragments the flash memory card
Hex Trace	Helps isolate the source of a print job problem	Activate	With Hex Trace active, all data sent to the printer is printed in hexadecimal and character representation. Control codes are not executed. <b>Note:</b> To exit Hex Trace, turn the printer off, or reset the printer from the Job Menu.
Coverage Estimator	Provides an estimate of the percent coverage of toner on a page. The estimate is printed on the page	Off*	Percent coverage is not printed.
		On	Prints the estimated percentage of coverage.
LCD Contrast	Adjusts the contrast of the control panel display	1 - 10	<b>5*</b> is the default setting. A higher value will make the display appear lighter, a lower value makes the display appear darker.
LCD Brightness	Adjusts the brightness of the control panel display	1 - 10	<b>5*</b> is the default setting. A higher value increases the brightness of the display, a lower value decreases the brightness of the display.

## Using printer menus

---

### PostScript Menu

Use this menu selection to change printer settings that affect jobs using the PostScript printer language.

Menu selection	Purpose	Values	
Print PS Error	Prints a page defining the PostScript emulation error when an error occurs	Off*	Discards the print job without printing an error message.
		On	Prints an error message before it discards the job.
Font Priority	Establishes the font search order. Font Priority is only displayed when a formatted flash is installed, is neither defective nor Read/Write or Write protected, and Job Buffer Size is not set to 100%.	Resident*	Printer searches printer memory for the requested font before searching flash memory.
		Flash	Printer searches the flash memory for the requested font before searching printer memory.

### PCL Emul Menu

Use this menu selection to change printer settings that affect jobs using the PCL emulation printer language.

Menu selection	Purpose	Values	
Font Source	Determines the set of fonts displayed in the Font Name menu item	Resident*	Displays all fonts resident in printer RAM when the printer ships from the factory
		Flash	Displays all fonts stored in flash memory
		Download	Displays all fonts downloaded to printer RAM
		All	Displays all fonts available to the printer from all sources
Font Name	Identifies a specific font from the specified font source	R0 Courier*	The font name and font ID for all fonts in the selected font source are displayed. The font source abbreviation is R for resident, F for flash, and D for download.
Symbol Set	Determines the symbol set for a specified font name	10U PC-8* (US) (country/region-specific factory default values)	A symbol set is a set of alphabetic and numeric characters, punctuation, and special symbols used when printing with a selected font. Symbol sets support the different requirements for languages or specific applications, such as math symbols for scientific text. Only the symbol sets supported for the selected font name are displayed.
		12U PC-850* (non-US) (country/region-specific factory default values)	

## Using printer menus

---

Menu selection	Purpose	Values	
PCL Emulation Settings	Specifies the font pitch for scalable monospaced fonts	Point Size: 1...1008 in increments of 0.25 points) (*12)	Point size refers to the height of the characters in the font. One point equals approximately 1/72 of an inch. You can select point sizes from 1 to 1008 in increments of 0.25 points.  Point Size is only displayed for typographic fonts.
	Specifies the font pitch for scalable monospaced fonts	Pitch: 0.08–100.00 (10*)	Pitch refers to the number of fixed-space characters in a horizontal inch of type. You can select a pitch from 0.08 to 100 characters per inch (cpi) in increments of 0.01 cpi. For nonscalable monospaced fonts, the pitch is displayed but cannot be changed.  <b>Note:</b> Pitch is only displayed for fixed, or monospaced, fonts.
	Determines how text and graphics are oriented on the page	Orientation: Portrait* Landscape	Portrait prints text and graphics parallel to the short edge of the paper.  Landscape prints text and graphics parallel to the long edge of the paper.
	Determines the number of lines that print on each page	Lines per Page: 1–255 60* (Americas) 64* (non-Americas)	The printer sets the amount of space between each line (vertical line spacing) based on the Lines per Page, Paper Size, and Orientation menu items. Select the correct Paper Size and Orientation before changing Lines per Page.
	Sets the width of the logical page for A4 size paper	A4 Width: 198 mm* 203 mm	<b>Note:</b> The 203 mm setting makes the logical page wide enough to print eighty 10-pitch characters.
	Specifies whether the printer automatically performs a carriage return after a line feed control command	Auto CR after LF: Off* On	<b>Off</b> —Printer does not perform a carriage return after a line feed control command. <b>On</b> —Printer performs a carriage return after a line feed control command.
	Specifies whether the printer automatically performs a line feed after a carriage return control command	Auto LF after CR: Off* On	<b>Off</b> —Printer does not perform a line feed after a carriage return control command. <b>On</b> —Printer performs a line feed after a carriage return control command.

## Using printer menus

Menu selection	Purpose	Values	
Tray Renumber	Configures the printer to work with printer drivers or applications that use different source assignments for the paper trays  <b>Note:</b> See the <i>Technical Reference</i> for more information about assigning source numbers.	Assign Tray [x]: Off* None 0–199	<b>Off</b> —Printer uses factory default paper source assignments. <b>None</b> —Paper source ignores the Select Paper Feed command. <b>0–199</b> —Select a numeric value to assign a custom value to a paper source.
		Assign Man Paper: Off* None 0–199	<b>Off</b> —Printer uses factory default paper source assignments. <b>None</b> —Paper source ignores the Select Paper Feed command. <b>0–199</b> —Select a numeric value to assign a custom value to a paper source.
		Assign Man Env: Off* None 0–199	<b>Off</b> —Printer uses factory default paper source assignments. <b>None</b> —Paper source ignores the Select Paper Feed command. <b>0–199</b> —Select a numeric value to assign a custom value to a paper source.
		View Factory Def	Displays the factory default value assigned to each paper source
		Restore Defaults	Select <b>Yes</b> to return all tray assignments to factory default values.

### PPDS Menu

Use the PPDS Menu to change printer settings that only affect jobs using the PPDS emulation printer language.

**Note:** The PPDS MENU is only displayed after the PPDS emulator has been activated.

Menu selection	Purpose	Values	
Orientation	Determines how text and graphics are oriented on the page	Portrait*	Prints text and graphics parallel to the short edge of the paper
		Landscape	Prints text and graphics parallel to the long edge of the paper
Lines per Page	Determines the number of lines that print on each page	1...255 (64*)	The printer sets the amount of space between each line (vertical line spacing) based on the Lines per Inch, Lines per Page, Paper Size, and Orientation menu items. Select the correct Paper Size and Orientation before changing Lines per Page.
Lines per Inch	Determines the number of lines that print per vertical inch	.25...30 (6*)	The printer sets the amount of space between each line (vertical line spacing) based on the Lines per Inch, Lines per Page, Paper Size, and Orientation menu items. Select the correct Paper Size and Orientation before changing Lines per Inch.

## Using printer menus

---

Menu selection	Purpose	Values	
Page Format	Affects how the printer interprets the margins set from software applications	Print*	Printer measures the margin settings from the inside edge of the left unprintable area and the bottom of the top unprintable area. The left and top margin areas on the print job are equal to the software margins setting plus the unprintable area.
		Whole	Printer measures margin settings from the top left edge of the paper. The left and top margins areas on the print job are equal to the software margins settings.
Character Set	Determines which code page to use to print PPDS jobs	1	The standard code pages are used.
		2*	The addresses from Value 1 change to represent characters and symbols used in non-US English languages.
Best Fit	Determines whether to perform a font best fit search if the requested font cannot be found	Off	Printer stops printing when a requested font cannot be found. An error message is posted indicating the font could not be found.
		On*	Printer continues even though it was not able to locate a requested font. Instead, the printer tries to select another font that best matches the characteristics of the requested font.
Tray 1 Renumber	Configures your printer to work with printer drivers or applications that use different source assignments for the paper trays  This menu item is only displayed when Tray 2 is installed.	Off*	Print jobs are printed from the requested source.
		Tray 2	Print job requests for Tray 2 are converted to requests for Tray 1. Print job requests for Tray 1 are converted to requests for Tray 2.
Auto CR after LF	Specifies whether the printer automatically performs a carriage return after a line feed control command	Off*	Printer does not perform a carriage return after a line feed control command.
		On	Printer performs a carriage return after a line feed control command.
Auto LF after CR	Specifies whether the printer automatically performs a line feed after a carriage return control command	Off*	Printer does not perform a line feed after a carriage return control command.
		On	Printer performs a line feed after a carriage return control command.

### Security

This menu selection is used to set security levels on individual print jobs.

Menu selection	Purpose	Values
Job Expiration	Limits the amount of time a confidential job stays in the printer before it is deleted	Off* 1 hour 4 hours 24 hours 1 week

## Using printer menus

---

### Network/Ports

#### TCP/IP

This menu section is used to view and change the Transmission Control Protocol/Internet Protocol settings.

**Note:** This menu is not displayed for non-network models.

Menu selection	Purpose	Values	
TCP/IP	Sets the network option to TCP/IP (Transmission Control Protocol/Internet Protocol)	Activate	On* Off
		View Hostname	View only
		Address	4 field IP address
		Netmask	
		Gateway	
		Enable DHCP	On* Off
		Enable RARP	
		Enable BOOTP	
		AutoIP	
		Enable FTP/TFTP	
		HTTP Server Enabled	
		WINS Server Address	4 field IP address
		DNS Server Address	

#### Standard Network

Use this menu selection to change printer settings affecting jobs sent to the printer through a network port (Standard Network).

Menu selection	Purpose	Values	
PCL SmartSwitch	Configures the printer so it automatically switches to PCL emulation when a print job received through the network port requires it, regardless of the default printer language	On*	Printer examines data on the network interface and selects PCL emulation if the data indicates that is the required printer language.
		Off	Printer does not examine the incoming data. The printer uses PostScript emulation to process the job if PS SmartSwitch is On, or uses the default printer language specified in the Setup Menu if PS SmartSwitch is Off.



## Using printer menus

Menu selection	Purpose	Values	
PS SmartSwitch	Configures the printer so it automatically switches to PostScript emulation when a print job received through the network port requires it, regardless of the default printer language	On*	Printer examines data on the network interface connection and selects PostScript emulation if the data indicates that is the required printer language.
		Off	Printer does not examine the incoming data. The printer uses PCL emulation to process the job if PCL SmartSwitch is On, or uses the default printer language specified in the Setup Menu if PCL SmartSwitch is Off.
NPA Mode	Specifies whether the printer performs the special processing required for bidirectional communication, following the conventions defined in the Network Printing Alliance (NPA) Protocol <b>Note:</b> Changing this menu item automatically resets the printer.	Off	The printer will not perform any NPA processing.
		Auto*	Printer examines the incoming data to determine the format. If the incoming data is not NPA packets, the information is passed to the printer as non-NPA.
Network Buffer	Configures the size of the network input buffer <b>Note:</b> Changing the Network Buffer menu item automatically resets the printer.	Auto*	Printer automatically calculates the Network Buffer size (recommended setting).
		3K to maximum size allowed (1k increments)	User specifies the Network Buffer size. The maximum size depends on the amount of memory in the printer, the size of the other link buffers, and whether Resource Save is set to On or Off. To maximize the range for the Network Buffer size, disable or reduce the size of the parallel, and USB buffers.
Mac Binary PS	Configures the printer to process Macintosh binary PostScript print jobs	On	Printer processes raw binary PostScript print jobs from computers using the Macintosh operating system. <b>Note:</b> This setting often causes Windows print jobs to fail.
		Off	Printer filters PostScript print jobs using standard protocol.
		Auto*	Printer processes print jobs from computers using either Windows or Macintosh operating systems.

### Standard USB

Use this menu selection to change printer settings affecting a Universal Serial Bus (USB) port.

Menu selection	Purpose	Values	
PCL SmartSwitch	Configures the printer so it automatically switches to PCL emulation when a print job received through the USB port requires it, regardless of the default printer language	On*	Printer examines the data on the USB port and selects PCL emulation if the data indicates that is the required printer language.
		Off	Printer does not examine the incoming data. The printer uses PostScript emulation to process the job if PS SmartSwitch is On, or uses the default printer language specified in the Setup Menu if PS SmartSwitch is Off.

## Using printer menus

---

Menu selection	Purpose	Values	
PS SmartSwitch	Configures the printer so it automatically switches to PostScript emulation when a print job received through the USB port requires it, regardless of the default printer language	On*	Printer examines data on the USB interface and selects PostScript emulation if the data indicates that is the required printer language.
		Off	Printer does not examine the incoming data. The printer uses PCL emulation to process the job if PCL SmartSwitch is On, or uses the default printer language specified in the Setup Menu if PCL SmartSwitch is Off.
NPA Mode	Specifies whether the printer performs the special processing required for bidirectional communication, following the conventions defined in the Network Printing Alliance (NPA) Protocol <b>Note:</b> Changing this menu item automatically resets the printer.	Off	The printer will not perform any NPA processing.
		On	All data received by the printer must be in NPA packets. Any non-packet data received will be rejected as bad.
		Auto*	Printer examines the incoming data to determine the format. If the incoming data is not NPA packets, the information is passed to the printer as non-NPA.
USB Buffer	Configures the size of the USB input buffer <b>Note:</b> Changing the USB Buffer menu item automatically resets the printer.	Disabled	Job buffering is disabled. Any jobs already buffered on the disk are printed before normal processing of incoming jobs resumes.
		Auto*	Printer automatically calculates the USB Buffer size (recommended setting).
		3K to maximum size allowed	User specifies the USB Buffer size. The maximum size depends on the amount of memory in the printer, the size of the other link buffers, and whether Resource Save is set to On or Off. To maximize the range for the USB Buffer size, disable or reduce the size of the parallel, and network buffers.
Mac Binary PS	Configures the printer to process Macintosh binary PostScript print jobs	Off	Printer processes raw binary PostScript print jobs from computers using the Macintosh operating system. <b>Note:</b> This setting often causes Windows print jobs to fail.
		On	Printer filters PostScript print jobs using standard protocol.
		Auto*	Printer processes print jobs from computers using either Windows or Macintosh operating systems.
ENA Address	Sets the USB port ENA Address	4 field IP address	Shown only if an ENA is attached through the USB port.
ENA Netmask	Sets the USB port ENA Netmask		
ENA Gateway	Sets the USB port ENA Gateway		

## Using printer menus

---

### AppleTalk

Use this menu selection to view or change the printer AppleTalk settings.

Menu selection	Purpose	Values	
View Name	Displays the assigned AppleTalk name	Selecting <b>View Name</b> displays the AppleTalk name on the control panel.	
View Address	Displays the assigned AppleTalk address	Selecting <b>View Address</b> displays the AppleTalk address on the control panel.	
Activate	Activates or deactivates the AppleTalk feature	On Off	<b>On</b> —Activates the AppleTalk feature. <b>Off</b> —Deactivates the AppleTalk feature.
Set Zone *	Provides a list of zones from network	Default will be default zone for the network. If no default zone exists on the network, the * will be the default.	

### Help

This menu selection is used to print some or all of the resident Help Menu Pages. These pages contain information about printer connectivity, print quality, paper tips, and supplies.

**Note:** If the control panel is set to another language, the document will be printed in English.

The Help Pages can be printed in the following languages.

English	German	Spanish	Norwegian	Swedish	Finnish	Polish
French	Italian	Danish	Dutch	Portuguese	Russian	

Menu selection	Purpose	Values
Printing Guide	Prints the Printing Guide topic.	After selecting this item, the Help menu topic will print, and the printer will return to <b>Ready</b> .
Supplies Guide	Prints the Supplies Guide topic.	
Media Guide	Prints the Media Guide topic.	
Print Defects	Prints the Print Defect sheet.	
Menu Map	Prints the Menu Map topic.	
Information Guide	Prints the Information Guide topic.	
Connection Guide	Prints the Connection Guide topic.	
Moving Guide	Prints the Moving Guide topic.	

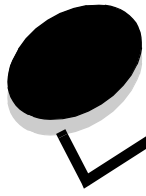

# Understanding printer messages

The printer operator panel displays messages describing the current state of the printer and indicates possible printer problems you must resolve. This topic provides a list of all printer messages, explains what they mean, and tells you how to clear the messages.

The following table lists the messages in alphanumerical order. You can also locate a message using the index.

Message	Action
Activating Menu Changes	Wait for the message to clear.
Busy	Wait for the message to clear, or cancel the print job.
Cancel not available	Wait for the message to clear.
Cancelling	Wait for the message to clear.
Change <src> <Custom Type Name>	<ul style="list-style-type: none"> <li>• If you have changed the media, press ▼ until ✓ Continue appears, and then press ✓.</li> <li>• To print on media currently in the printer, press ▼ until ✓ Continue appears, and then press ✓.</li> <li>• Change the print media orientation.</li> <li>• Cancel the current job.</li> </ul>
Change <src> <Custom String>	
Change <src> <size>	
Change <src> <type> <size>	
Close door <x>	Close the specified door to clear the message.
Copies	Enter the desired number of copies.
Defragmenting Flash DO NOT POWER OFF	<b>Warning:</b> Do not turn the printer off while this message is displayed. Wait for the message to clear.
Deleting	Wait for the message to clear.
Disabling DLEs	Wait for the message to clear.
Disabling Menus	Wait for the message to clear. <b>Note:</b> While the menus are disabled, you cannot change the printer settings from the operator panel.
Enabling Menus	Wait for the message to clear.
Flushing buffer	Wait for the message to clear.
Formatting Flash DO NOT POWER OFF	<b>Warning:</b> Do not turn the printer off while this message is displayed. Wait for the message to clear.
Insert print cartridge	Insert the print cartridge to clear the message.
Insert Tray <x>	Insert the specified tray into the printer.
Internal System Error Reload Bookmarks	<ul style="list-style-type: none"> <li>• Reload the Bookmarks.</li> <li>• To clear the message and continue printing, press ▼ until ✓ Continue appears, and then press ✓.</li> </ul>
Internal System Error, Reload Security Certificates	<ul style="list-style-type: none"> <li>• Reload the Security Certificates.</li> <li>• To clear the message and continue printing, press ▼ until ✓ Continue appears, and then press ✓.</li> </ul>
Invalid Network Code	Download valid code to the internal print server. <b>Note:</b> You can download network code while this message is displayed.

## Understanding printer messages

Message	Action
Invalid Engine Code	Download valid engine code to the printer. <b>Note:</b> You can download engine code while this message is displayed.
Load manual feeder with <Custom Type>	<ul style="list-style-type: none"> <li>Load the specified paper in the manual feed tray or multipurpose feeder.</li> <li>To ignore the manual feed request and print on paper already installed in one of the input sources, press ▼ until ✓ Continue appears, and then press Ⓢ.</li> </ul> <p>If the printer finds a tray that has paper of the correct type and size, it feeds paper from that tray. If the printer cannot find a tray with the correct paper type and size, it prints on whatever paper is installed in the default input source.</p> <ul style="list-style-type: none"> <li>Cancel the current job.</li> </ul>
Load manual feeder with <Custom String>	
Load manual feeder with <size>	
Load manual feeder with <size> <type>	
Load <src> with <Custom Type Name>	
Load <src> with <Custom String>	<ul style="list-style-type: none"> <li>Load the input source with the correct type and size media.</li> <li>Cancel the current job.</li> </ul>
Load <src> <size>	
Load <src> <type> <size>	
Load <src> <type> <size>	
Maintenance	Replace the maintenance items and, if necessary, reset the printer maintenance counter.
Menus are Disabled	The printer menus are disabled. You cannot change the printer settings from the operator panel. <b>Note:</b> You can still cancel a job, print a confidential job, or print a held job. Contact your system support person.
Network	A network interface is the active communication link.
Network <x>, <y>	A network interface is the active communication link, where <x> represents the active communication link, and <y> represents the channel.
No held jobs	Wait for the message to clear.
No jobs to cancel	Wait for the message to clear.
Parallel	A parallel interface is the active communication link.
Power Saver	<ul style="list-style-type: none"> <li>Send a job to print.</li> <li>Press Ⓢ to warm the printer to normal operating temperature and display the Ready message.</li> </ul>
Printing	Wait for the message to clear.
Printer busy Continue Quit	<ul style="list-style-type: none"> <li>To read the information from the USB drive, press ▼ until ✓ Continue appears, and then press Ⓢ.</li> <li>To cancel the information retrieval process, press ▼ until ✓ Quit appears, and then press Ⓢ.</li> </ul>
Programming System Code	<b>Warning:</b> Do not turn the printer off while this message is displayed. Wait for the message to clear and the printer to reset.
Programming Flash	<b>Warning:</b> Do not turn the printer off while this message is displayed. Wait for the message to clear.
Ready	Send a job to print.
Remote Management Active DO NOT POWER OFF	The printer settings are being configured, and the printer was taken offline to ensure it is not currently printing and processing jobs. Wait for the message to clear.
Remove paper from std bin	Remove the paper from the standard bin.
Resetting the Printer	Wait for the message to clear.

## Understanding printer messages

Message	Action
Restoring Factory Defaults	<p>Wait for the message to clear.</p> <p><b>Note:</b> When factory default settings are restored:</p> <ul style="list-style-type: none"> <li>• All downloaded resources (fonts, macros, symbol sets) in the printer memory are deleted.</li> <li>• All menu settings return to the factory default setting <i>except</i>: <ul style="list-style-type: none"> <li>– The Display Language setting in the Setup Menu.</li> <li>– All settings in the Parallel Menu, Network Menu, Infrared Menu, LocalTalk Menu, USB Menu, and Fax Menu.</li> </ul> </li> </ul>
Some held jobs were deleted	<ul style="list-style-type: none"> <li>• To clear the message and continue printing, press ▼ until ✓ Continue appears, and then press ⓧ.</li> </ul> <p>The printer frees memory by deleting the oldest held job and continues deleting held jobs until there is enough printer memory to process the job.</p> <ul style="list-style-type: none"> <li>• Cancel the current job.</li> </ul>
Submitting selection	Wait for the message to clear.
Toner Empty	<ul style="list-style-type: none"> <li>• Replace the toner cartridge.</li> </ul>
Toner Low	<ul style="list-style-type: none"> <li>• Replace the toner cartridge.</li> <li>• Press ⓧ to clear the message and continue printing.</li> </ul>
USB	The printer is processing data through the specified USB port.
View supplies	Displays the current level of all printer supplies.
Waiting	<p>The printer has received a page of data to print, but is waiting for an End of Job command, a Form Feed command, or additional data.</p> <ul style="list-style-type: none"> <li>• Press ⓧ to print the contents of the buffer.</li> <li>• Cancel the current job.</li> </ul>
1565 Emul Error Load Emul Option	<p>The printer automatically clears the message in 30 seconds, and then disables the download emulator on the firmware card.</p> <p>Download the correct download emulator version from the Lexmark Web site.</p>
31 Replace defective or missing toner cartridge	Insert or replace the toner cartridge.
32 Replace unsupported print cartridge	Install a toner cartridge that is the correct type and capacity for this printer.
34 Short Paper	<ul style="list-style-type: none"> <li>• Load the appropriate media in the selected source.</li> <li>• To clear the message and print the job using a different paper source, press ▼ until ✓ Continue appears, and then press ⓧ.</li> </ul>
35 Insufficient memory to support Resource Save feature	<ul style="list-style-type: none"> <li>• To disable Resource Save and continue printing, press ▼ until ✓ Continue appears, and then press ⓧ.</li> <li>• To enable Resource Save after you get this message: <ul style="list-style-type: none"> <li>– Make sure the link buffers are set to Auto, then exit the menus to activate the link buffer changes.</li> <li>– When Ready is displayed, enable Resource Save.</li> </ul> </li> <li>• Install additional memory.</li> </ul>
37 Insufficient memory to collate job	<ul style="list-style-type: none"> <li>• To print the portion of the job already stored and begin collating the rest of the job, press ▼ until ✓ Continue appears, and then press ⓧ.</li> <li>• Cancel the current job.</li> </ul>
37 Insufficient memory for Flash Memory Defragment operation	<ul style="list-style-type: none"> <li>• To stop the defragment operation and continue printing, press ▼ until ✓ Continue appears, and then press ⓧ.</li> <li>• Delete fonts, macros, and other data in printer memory.</li> <li>• Install additional printer memory.</li> </ul>

## Understanding printer messages

Message	Action
37 Insufficient memory, some held jobs were lost	The printer was unable to restore some or all of the confidential or held jobs on the hard disk. To clear the message, press ▼ until ✓ Continue appears, and then press ✓.
38 Memory Full	<ul style="list-style-type: none"> <li>• To clear the message and continue printing, press ▼ until ✓ Continue appears, and then press ✓.</li> <li style="padding-left: 20px;">The job may not print correctly.</li> <li>• Cancel the current job.</li> <li>• Install additional printer memory.</li> </ul>
39 Page is too complex to print	<ul style="list-style-type: none"> <li>• To clear the message and continue printing, press ▼ until ✓ Continue appears, and then press ✓.</li> <li style="padding-left: 20px;">The job may not print correctly.</li> <li>• Cancel the current job.</li> <li>• Install additional printer memory.</li> </ul>
Message 42.xy Cartridge region mismatch	Install a toner cartridge that matches the printer's region number. For more information, see the <i>User's Guide</i> on the <i>Software and Documentation CD</i> .
50 PPDS font error	<ul style="list-style-type: none"> <li>• To clear the message and continue printing, press ▼ until ✓ Continue appears, and then press ✓.</li> <li style="padding-left: 20px;">The job may not print correctly.</li> <li>• Cancel the current job.</li> </ul>
51 Defective flash detected	To clear the message and continue printing, press ▼ until ✓ Continue appears, and then press ✓. You must install different flash memory before you can download any resources to flash.
52 Not enough free space in flash memory for resources	<ul style="list-style-type: none"> <li>• To clear the message and continue printing, press ▼ until ✓ Continue appears, and then press ✓.</li> <li style="padding-left: 20px;">Downloaded fonts and macros not previously stored in flash memory are deleted.</li> <li>• Delete fonts, macros, and other data stored on the flash memory.</li> <li>• Install a larger capacity flash memory card.</li> </ul>
53 Unformatted flash detected	To clear the message and continue printing, press ▼ until ✓ Continue appears, and then press ✓. You must format the flash memory before you can store any resources on it. If the error message remains, the flash memory may be defective and require replacing.
54 Standard network software error	<ul style="list-style-type: none"> <li>• To clear the message and continue printing, press ▼ until ✓ Continue appears, and then press ✓.</li> <li style="padding-left: 20px;">The job may not print correctly.</li> <li>• Program new firmware for the network interface.</li> <li>• Reset the printer.</li> </ul>
56 Standard parallel port disabled	<ul style="list-style-type: none"> <li>• To clear the message, press ▼ until ✓ Continue appears, and then press ✓.</li> <li style="padding-left: 20px;">The printer discards any data received through the parallel port.</li> <li>• Make sure the Parallel Buffer menu item is not set to Disabled.</li> </ul>
56 Standard USB port disabled	<ul style="list-style-type: none"> <li>• To clear the message, press ▼ until ✓ Continue appears, and then press ✓.</li> <li style="padding-left: 20px;">The printer discards any data received through the USB port.</li> <li>• Make sure the USB Buffer menu item is not set to Disabled.</li> </ul>
58 Too many flash options installed	<ol style="list-style-type: none"> <li>1 Turn off and unplug the printer.</li> <li>2 Remove the excess flash memory.</li> <li>3 Plug in the printer, and turn it on.</li> </ol>

## Understanding printer messages

Message	Action
80 Scheduled maintenance advised	<ul style="list-style-type: none"> <li>• To clear the message, and continue printing, press ▼ until ✓ Continue appears, and then press ⓧ.</li> <li>• Replace the maintenance items and if necessary, reset the printer maintenance counter.</li> </ul>
84 Insert PC unit	Insert the photoconductor unit.
84 PC Unit life warning	<ul style="list-style-type: none"> <li>• To clear the message, and continue printing, press ▼ until ✓ Continue appears, and then press ⓧ.</li> <li>• Replace the photoconductor unit.</li> </ul>
84 Replace PC unit	<ul style="list-style-type: none"> <li>• To clear the message, and continue printing, press ▼ until ✓ Continue appears, and then press ⓧ.</li> <li>• Replace the photoconductor unit.</li> </ul>
84 PC unit abnormal	<ul style="list-style-type: none"> <li>• Replace the photoconductor unit.</li> </ul>
88 Toner is low	<ul style="list-style-type: none"> <li>• Replace the toner cartridge.</li> <li>• To clear the message, and continue printing, press ▼ until ✓ Continue appears, and then press ⓧ.</li> </ul>
88 Replace toner	<ul style="list-style-type: none"> <li>• Replace the toner cartridge.</li> <li>• To clear the message, and continue printing, press ▼ until ✓ Continue appears, and then press ⓧ.</li> </ul>
200.yy Paper jam	<ol style="list-style-type: none"> <li>1 Clear the paper path.</li> <li>2 After clearing the paper path, press ▼ until ✓ Continue appears, and then press ⓧ to resume printing.</li> </ol>
201.yy Paper jam	<ol style="list-style-type: none"> <li>1 Clear the paper path.</li> <li>2 After clearing the paper path, press ▼ until ✓ Continue appears, and then press ⓧ to resume printing.</li> </ol>
202.yy Paper jam	<ol style="list-style-type: none"> <li>1 Clear the paper path.</li> <li>2 After clearing the paper path, press ▼ until ✓ Continue appears, and then press ⓧ to resume printing.</li> </ol>
231.yy Paper jam	<ol style="list-style-type: none"> <li>1 Clear the paper path.</li> <li>2 After clearing the paper path, press ▼ until ✓ Continue appears, and then press ⓧ to resume printing.</li> </ol>
233.yy Paper jam	<ol style="list-style-type: none"> <li>1 Clear the paper path.</li> <li>2 After clearing the paper path, press ▼ until ✓ Continue appears, and then press ⓧ to resume printing.</li> </ol>
234.yy Paper jam	<ol style="list-style-type: none"> <li>1 Clear the paper path.</li> <li>2 After clearing the paper path, press ▼ until ✓ Continue appears, and then press ⓧ to resume printing.</li> </ol>
235.yy Paper jam	<ol style="list-style-type: none"> <li>1 Clear the paper path.</li> <li>2 After clearing the paper path, press ▼ until ✓ Continue appears, and then press ⓧ to resume printing.</li> </ol>
241 Paper jam	<ol style="list-style-type: none"> <li>1 Clear the paper path.</li> <li>2 After clearing the paper path, press ▼ until ✓ Continue appears, and then press ⓧ to resume printing.</li> </ol>
242 Paper jam	<ol style="list-style-type: none"> <li>1 Clear the paper path.</li> <li>2 After clearing the paper path, press ▼ until ✓ Continue appears, and then press ⓧ to resume printing.</li> </ol>



## Understanding printer messages

---

Message	Action
251 Paper jam	<ol style="list-style-type: none"><li>1 Clear the paper path.</li><li>2 After clearing the paper path, press ▼ until ✓ Continue appears, and then press ⓧ to resume printing.</li></ol>
900-999 Service <message>	<ol style="list-style-type: none"><li>1 Turn the printer off.</li><li>2 Unplug the power cord from the wall.</li><li>3 Check all cable connections.</li><li>4 Plug in the power cord.</li><li>5 Turn the printer back on.</li></ol> <p>If the service message recurs, call for service, and report the message number and description of the problem.</p>

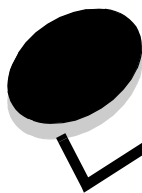

# Index

---

## Numerics

- 1565 Emul Error Load Emul Option 30
- 200.yy Paper jam 32
- 201.yy Paper jam 32
- 202.yy Paper jam 32
- 231.yy Paper jam 32
- 241.yy Paper jam 32
- 242.yy Paper jam 32
- 243.yy Paper jam 32
- 244.yy Paper jam 32
- 245.yy Paper jam 32
- 250.yy Paper jam 33
- 31 Replace defective or missing toner cartridge 30
- 37 Insufficient memory, some held jobs were lost 31
- 38 Memory Full 31
- 51 Defective flash detected 31
- 52 Not enough free space in flash memory for resources 31
- 53 Unformatted flash detected 31
- 54 Standard network software error 31
- 56 Standard parallel port disabled 31
- 56 Standard USB port disabled 31
- 58 Too many flash options installed 31
- 80 Scheduled maintenance 32
- 84 Insert PC unit 32
- 84 PC unit abnormal 32
- 84 PC Unit life warning 32
- 84 Replace PC unit 32
- 88 Replace toner 32
- 88 Toner is low 32
- 900–999 Service 33

## A

- Activate, AppleTalk 27
- Activating Menu Changes 28
- AppleTalk 27
- Auto CR after LF (PCL Emul Menu) 23
- Auto LF after CR (PCL Emul Menu) 23

## B

- Back button 5
- Blank Pages 17
- Busy 28
- button
  - back 5
  - menu 5
  - stop 5

## C

- Cancel not available 28
- Cancelling Job 28
- Change 28
- Change src, Custom Type Name, load orientation 28
- Close door 28
- Collation, enabling 17
- complex page errors 16
- Connection Guide, help 27
- Copies 28
- Copies, specifying number 17
- Coverage Estimator 19
- Custom Paper Type 11
- custom paper type 11

## D

- Default Source 7
- Defragmenting Flash 28
- Deleting 28
- Device Statistics 12
- diagram, menu 4
- directory printing 13
- Disabling DLEs 28
- Disabling Menus 28
- Display Language 13
- display panel 6
- Download Target (Setup Menu) 16
- downloaded resources
  - storing 16
- duplex binding 17
- duplex enabling 16

## E

- Emulation Settings, PCL 21
- ENA Address, USB 26
- ENA Gateway, USB 26
- ENA Netmask, USB 26
- Enabling Menus 28

## F

- Factory Defaults 19
- Feed Direction 11
- Finishing Menu 16
- flash memory
  - setting as download target 16
- Flushing buffer 28
- Font Name, PCL 20

- font printing 12
- Font Priority (PostScript Menu) 20
- Font Source, PCL 20
- fonts
  - priority 20
- Formatting Flash 28

## H

- hard disk
  - setting as download target 16
- help
  - Connection Guide 27
  - Information Guide 27
  - Media Guide 27
  - Menu Map 27
  - Moving Guide 27
  - Print Defects 27
  - Supplies Guide 27
- Help Menu 27
- help, Printing Guide 27
- Hex Trace 19

## I

- Information Guide, help 27
- Insert print cartridge 28
- Insert Tray <x> 28
- Internal System Error Reload Bookmarks 28
- Internal System Error, Reload Security Certificates 28
- Invalid Engine Code 29
- Invalid Network Code 28

## J

- Job Expiration 23

## L

- language, display 13
- language, printer 16
- LCD Brightness 19
- LCD Contrast 19
- Lines per Page (PCL Emul Menu) 22
- Load Manual <Custom String> 29
- Load Manual <Custom Type> 29
- Load Manual <size> 29
- Load Manual <size> <type> 29
- Load, src with, Custom String 29
- Load, src with, Custom Type Name 29
- Load, src, size 29
- Load, src, type, size 29
- loading paper 10

## M

- Mac Binary PS, network 25
- Mac Binary PS, USB 26
- Maintenance 29
- Manual Envelope Size 8

- Manual Envelope Type 8
- Manual Paper Size 8
- Manual Paper Type 8
- Media Guide, help 27
- Menu button 5
- menu diagram 4
- Menu Map, help 27
- Menu Settings Page 12
- Menus are Disabled 29
- Moving Guide, help 27
- Multipage Border 18
- Multipage Order 18
- Multipage Print 17
- Multipage View 18

## N

- Network Buffer 25
- Network interface 29
- network option 24
- Network Ports 24
- Network Setup Page 12
- No held jobs 29
- No jobs to cancel 29
- NPA Mode, network 25
- NPA Mode, USB 26

## O

- operator panel 5
- Orientation (PCL Emul Menu) 22

## P

- Page Protect (Setup Menu) 16
- panel, display 6
- panel, operator 5
- Paper Loading 10
- paper menu 7
- Paper Size 7
- Paper Texture 9, 10
- Paper Type 7
- paper type, custom 11
- Parallel interface 29
- PCL Emul Menu
  - Auto CR after LF 23
  - Auto LF after CR 23
  - Lines per Page 22
  - Orientation 22
  - Tray Renumber 23
- PCL emulation
  - automatic carriage return 23
  - automatic line feed 23
  - lines per page 22
  - orientation 22
  - tray renumber 23
- PCL emulation settings 21
- PCL font name 20
- PCL font source 20

# Index

---

PCL Menu 20  
PCL SmartSwitch, network 24  
PCL SmartSwitch, USB 25  
PCL symbol set 20  
PCL tray renumber 22  
PDF Menu 20  
Portrait Height 11  
Portrait Width 11  
PostScript emulation  
  font priority 20  
PostScript Menu 20, 22  
  Font Priority 20  
Power Saver 14, 29  
Print Area 16  
Print Defects, help 27  
Print Directory 13  
Print Fonts 12  
Print PS Error 20  
Print Recovery 15  
Print Resolution 18  
Printer busy 29  
Printer Language 16  
Printing 29  
Printing Guide, help 27  
Programming Flash 29  
Programming System Code 29  
PS emulation  
  See PostScript emulation  
PS SmartSwitch, network 25  
PS SmartSwitch, USB 26

## Q

Quality Menu 18

## R

Ready 29  
Remote Management Active 29  
Remove paper from standard output bin 29  
Reports 12  
Resetting the Printer 29  
Resource Save 16  
Restoring Factory Defaults 30

## S

saving power 14  
Security 23  
Separator Sheets 17  
Separator Source 17  
Set Zone, AppleTalk 27  
settings 13  
Setup Menu 13  
  Download Target 16  
  Page Protect 16  
Some held jobs were lost 30  
standard network 24  
Stop button 5

Submitting selection 30  
Substitute Size 9  
Supplies Guide, help 27  
Symbol Set, PCL 20

## T

TCP/IP 24  
Textured Paper 9, 10  
Timeouts 15  
Toner Darkness 18  
Toner Empty 30  
Toner Low 30  
Tray <x> Size 7  
Tray <x> Type 8  
Tray Renumber (PCL Emul Menu) 23  
Tray Renumber, PCL 22

## U

Units of Measure 11  
Universal Paper Size 11  
USB 30  
USB Buffer 26  
Utilities Menu 19

## V

View Address, AppleTalk 27  
View Name, AppleTalk 27  
View supplies 30

## W

Waiting 30