

Printing

Paper handling

Maintenance

Troubleshooting

Administration

Index

The fuser is one of the items in the maintenance kit. Replace it when **80 Scheduled Maintenance** appears.

Removing the old fuser

- 1 Turn the printer off.
- 2 If the envelope feeder is attached to the printer, remove it. See **Removing the optional envelope feeder**.
- 3 If a duplex unit is attached to the printer, open the duplex unit door (Door E).
 - a Push up on the latch to release the door.

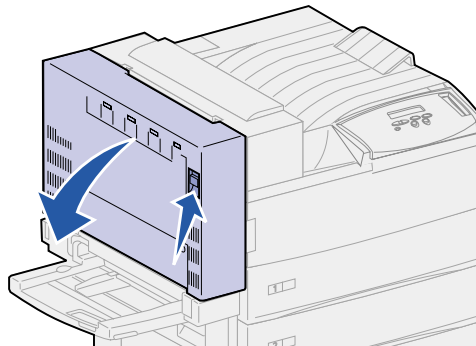

Printing

Paper handling

Maintenance

Troubleshooting

Administration

Index

- b** Gently lower the door to the open position.
- 4** Pull up on the handle to open the printer side door (Door A). Gently lower the door to the open position.
- 5** Using the handholds located on each side, pull open the printer front door (Door F).

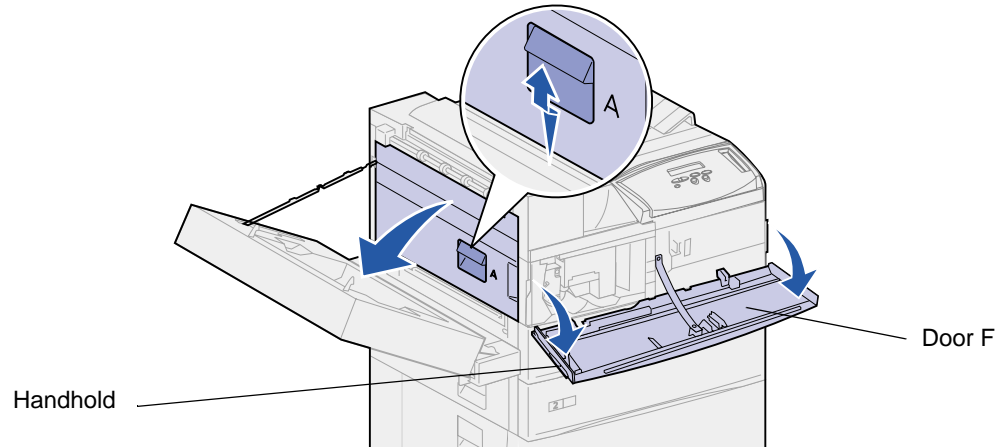

CAUTION! The fuser may be hot. Allow time for it to cool before continuing. Use the handles on the fuser to remove it.



Printing

Paper handling

Maintenance

Troubleshooting

Administration

Index

6 Loosen the two green thumbscrews. They do not come completely out.

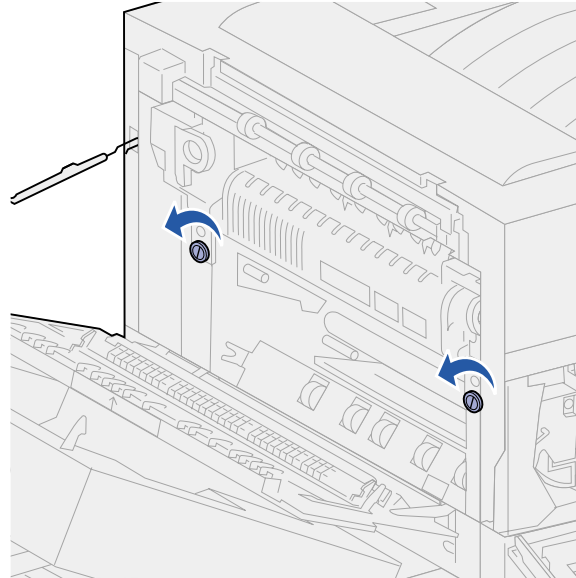

Printing

Paper handling

Maintenance

Troubleshooting

Administration

Index

- 7 Grasp the green handle through its ring and pull it forward. The handle slides up and locks into the open position.

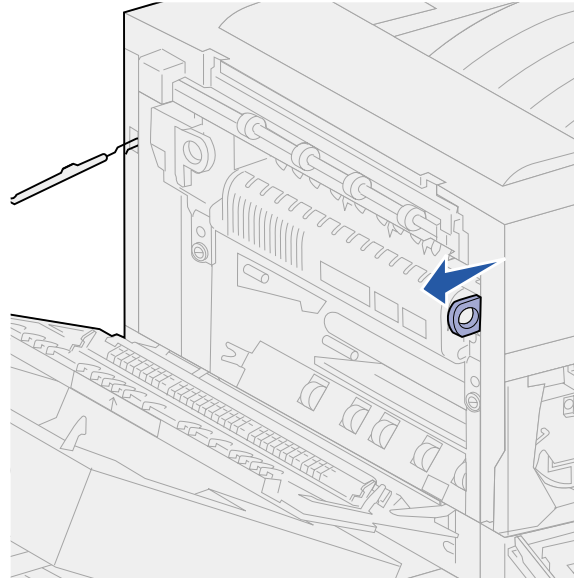

Printing

Paper handling

Maintenance

Troubleshooting

Administration

Index

- 8 Grasp the recessed green handle through its ring and rotate it out toward you. It does not lock into position.

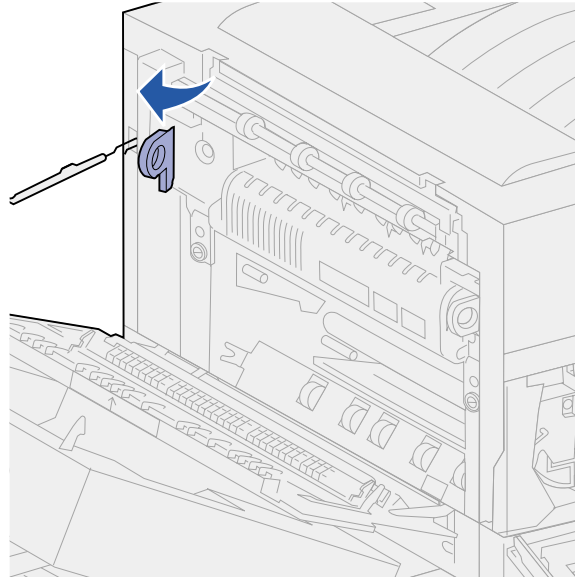

Printing

Paper handling

Maintenance

Troubleshooting

Administration

Index

- 9 Grasp both handles and firmly pull the fuser out.

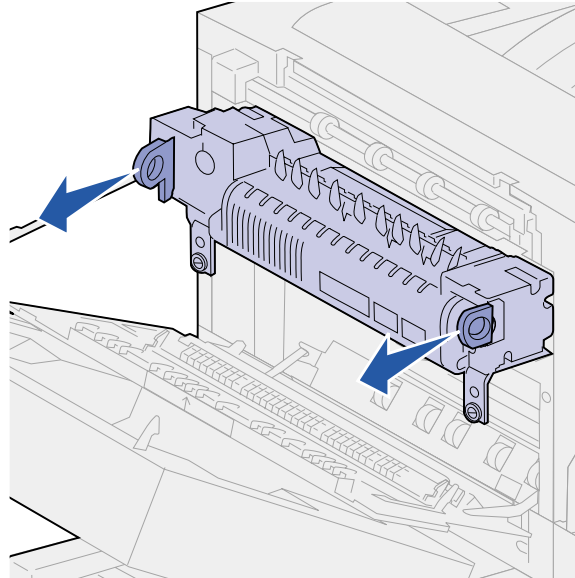

- 10 Dispose of the old fuser.



Printing

Paper handling

Maintenance

Troubleshooting

Administration

Index

Installing a new fuser

- 1 Remove the packaging from the new fuser.
- 2 Pull the labels off of each side of the fuser.

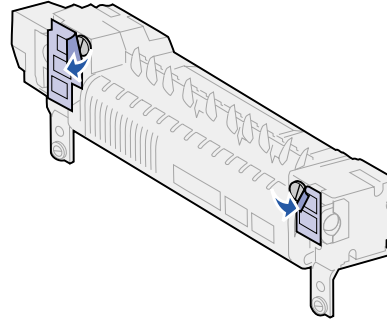

Printing

Paper handling

Maintenance

Troubleshooting

Administration

Index

- 3 Use a flat blade screwdriver or a coin to turn each screw until they are loose.

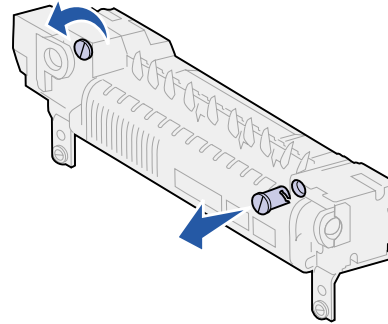

- 4 Pull the screws straight out, and then discard them.



Printing

Paper handling

Maintenance

Troubleshooting

Administration

Index

- 5 Grasp the right handle through its ring and pull it to the front. It slides up and locks into the open position.
- 6 Grasp the left handle through its ring and rotate it out toward you. It does not lock into position.

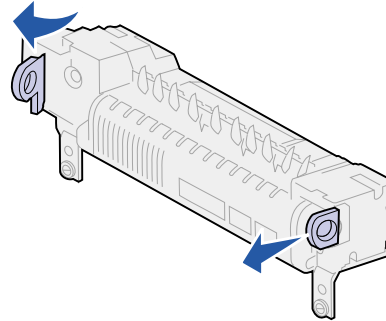

Printing

Paper handling

Maintenance

Troubleshooting

Administration

Index

- 7 Align the fuser with the opening in the printer, and then slide it into place.

Note: Push firmly on each side of the fuser near the handles until it is in place.

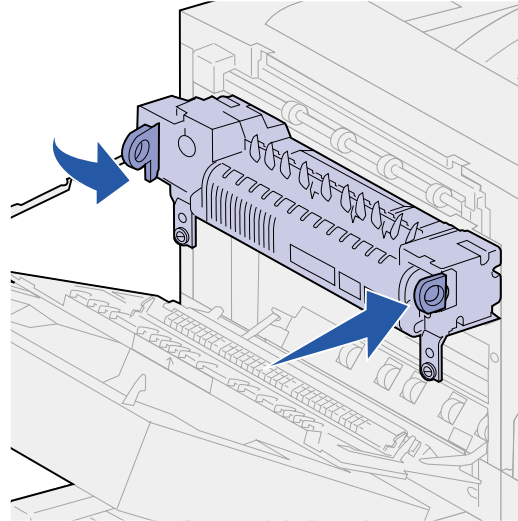

- 8 Push both handles back to their original positions.



Printing

Paper handling

Maintenance

Troubleshooting

Administration

Index

- 9 Carefully tighten the green thumbscrews.

Warning: Overtightening the screws can strip the threads.

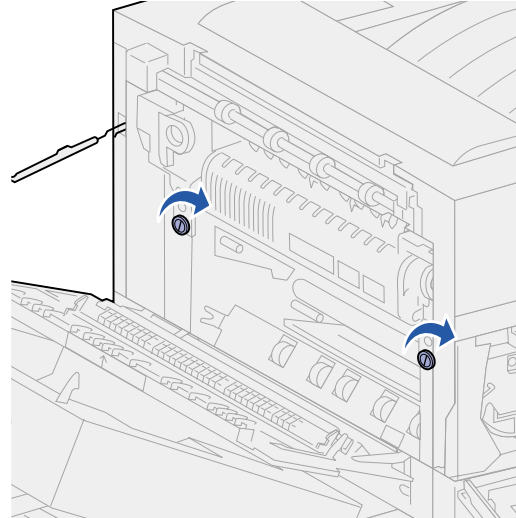

- 10 Close the printer front door (Door F).
- 11 Close the printer side door (Door A).
- 12 If the duplex unit is attached to the printer, close the duplex unit door (Door E).



Printing

Paper handling

Maintenance

Troubleshooting

Administration

Index

- 13 Reinstall the envelope feeder if it was removed. See **Reinstalling the envelope feeder**.
- 14 If you have already replaced all the items listed in the following note, you may turn the printer on.

Note: Make sure you also follow the instructions in **Replacing the transfer roller**, **Replacing pick rollers**, **Cleaning the wiper blade**, and **Resetting the maintenance page counter**. ▲

